

Specification

Model	Ultraloq UL3 BT
Sensor	Optical fingerprint sensor
Sensor Wake Up Mode	Touch
Scan Area	0.9 x 0.7 inch / 22.9 x 17.8 mm
Resolution	500 DPI
Fingerprint Capacity	95
Code Capacity	95
Identification Mode	Fingerprint, Bluetooth 4.0, code
Identification Time	<0.5 Sec
FRR (False Rejection Rate)	0.001%
FAR (False Acceptance Rate)	0.00001%
Finish	Satin Nickel, aged Bronze, bright Brass
Case Material	Strong Zinc Alloy
Working Voltage	4.5V (3 x AA batteries included)
Working Temperature	Outside lock body: -31°F (-35°C) to 158°F (70°C) Inside lock body: 14°F (-10°C) to 131°F (55°C)
Reversible Handle	Yes
Dimension	3.5 x 6.3 x 7 inch / 89 x 160 x 178 mm (front panel) 3.3 x 6.3 x 7 inch / 84 x 160 x 178 mm (back panel)
Weight	5.5 Pounds / 2.5 Kilograms
Door Thickness	1 ³ / ₈ " ~ 1 ³ / ₄ " (35 - 44 mm)



Get the free Ultraloq App



 It's all about you.

© 2016 U-tec Group Inc. All rights reserved.
U-tec and Ultraloq brands and products are trademarked and protected under law in the United States. Unauthorized use is prohibited. Ultraloq is sub-brand of U-tec Group Inc.

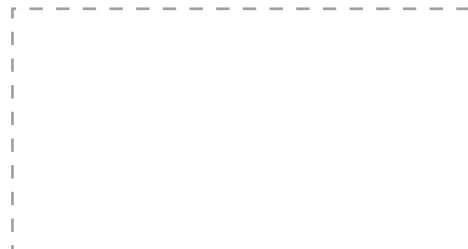

ultralba

UL3 BT

BLUETOOTH ENABLED
FINGERPRINT AND
TOUCHSCREEN
SMART LOCK

Simplify Your Safety

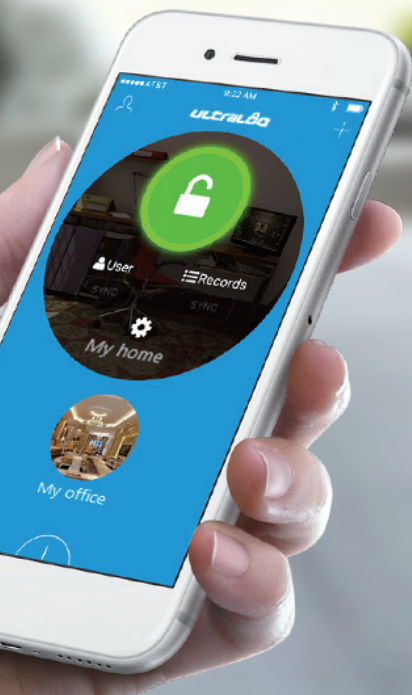

Welcome To A New Generation Of Keyless

Ultraloq UL3 BT smart lever lock is designed to be "RealKeyless" for maximum flexibility and convenience. You are free to use fingerprint, code, key or smartphone to unlock. You can just knock on your phone to open the door, even when it's in your pocket. You will be never be locked out again!



Bluetooth 4.0 Low Energy Connectivity

Your smartphone is now your key. Just unlock your door using the Ultraloq App on your smartphone.



Sense-on

When you reach out your finger to the touch keypad or fingerprint reader, Ultraloq will be activated automatically and ready for your operation.



Anti-peep Touchscreen

95 user defined 4-8 digit codes. Anti-peep touch keypad technology.



Up to 1 Year Battery Life

3 AA batteries. Up to 8,000 times access. Low battery alarm on App and display.



Advanced Fingerprint Identification

95 fingerprints. Identifies you in less than 0.5 second & works well for kids and the elder.



Solid and Resistant

The solid one-piece Zinc Alloy body is IP65 rated and completely waterproof and dustproof. Ideal for both indoor and outdoor installation.



Knock to Open

You don't have to open app. Just knock on your phone, even when it's in your pocket and you're in.

Welcome

Intuitive OLED Display

Use touchscreen to simply add or delete user on the device. An OLED screen with intuitive information will walk you through the whole process.



Hidden Backup Key

3 mechanical keys for backup. A keyhole is positioned specially on the bottom to give extra security in case of keyhole hackers.



Three Locking Modes

Auto relock, privacy lockout and free passage.



How Does Ultralog Work For You?

Tired of forgetting or losing your key?

More options. Fewer headaches. With Ultralog, you have the flexibility to use your finger or code to open your door. Now you will never be locked out again!

A rent home owner?

You can manage all renters' access and share them code for their temporary stay. No more key losses. Both you and your renters will have peace of mind.

Your employees quit without returning their keys?

No more waste of time and money replacing locks or exchanging keys. Just take few seconds to delete their fingerprints or codes.

Keep kids away from where gun is stored and protect your valuables

Our advanced fingerprint technology can keep your kids away from guns and protect valuables in your home office, home to garage door, wine cellar or storage room. Your fingerprint is unique and can never be forgotten or stolen.

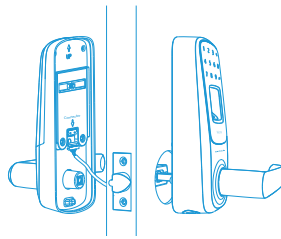

Designed For DIY Installation

Battery operated. No wiring.
In about 10 minutes, you are ready to go.

Ultralog App

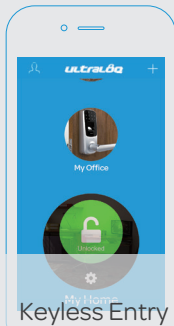

Keyless Entry

Ultralog App enables you to unlock your door with your smartphone.

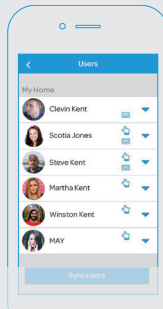

View Users

Knows who has the access to your lock and how.

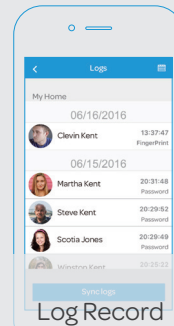

Log Record

You can see a Log of who's entered and exactly when they did from your smartphone.

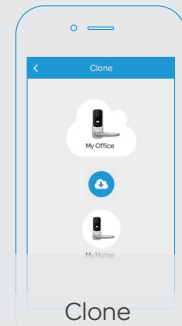

Clone

When you install another lock, just use Clone to transfer all users in one shot.

As Seen On



"Smart lock is convenient, but it is difficult for people who do not have a smart phone. For this reason, Ultralog has come in combination with the personal identification number and fingerprint authentication as well as smartphone control."

Geeky Gadgets

"A new Bluetooth enabled fingerprint and touchscreen smart lock has been created called the Ultralog UL3 BT, that has been designed to be 'RealKeyless' for maximum flexibility and convenience."



"Outfitted with a fingerprint scanner, the 'Ultralog' can also be accessed via the touch keypad with one major security breakthrough. To help thwart thieves or someone spying the 'Ultralog' will open even if a randomized set of numbers is entered (given that the correct code is in there somewhere)."

GADGETSIN

"Using integrated fingerprint scanner, anti-peep password and built-in Bluetooth, Ultralog UL3 BT smart lock provides a secure and intelligent method to guard the door."

